



EDGEMARK

**PROPOSED
MULTI-TENANT OUTLOT BUILDING**



and
**THREE LOTS AVAILABLE
FOR GROUND LEASE**

on **5.09 Acres**

SWC RANDALL RD & ALEXANDRA BLVD
Crystal Lake, Illinois 60014

EDGEMARK COMMERCIAL REAL ESTATE SERVICES LLC
2215 York Road, Suite 503
Oak Brook, IL 60523
P 630.472.1010 F 630.472.1019
www.edgemarkllc.com

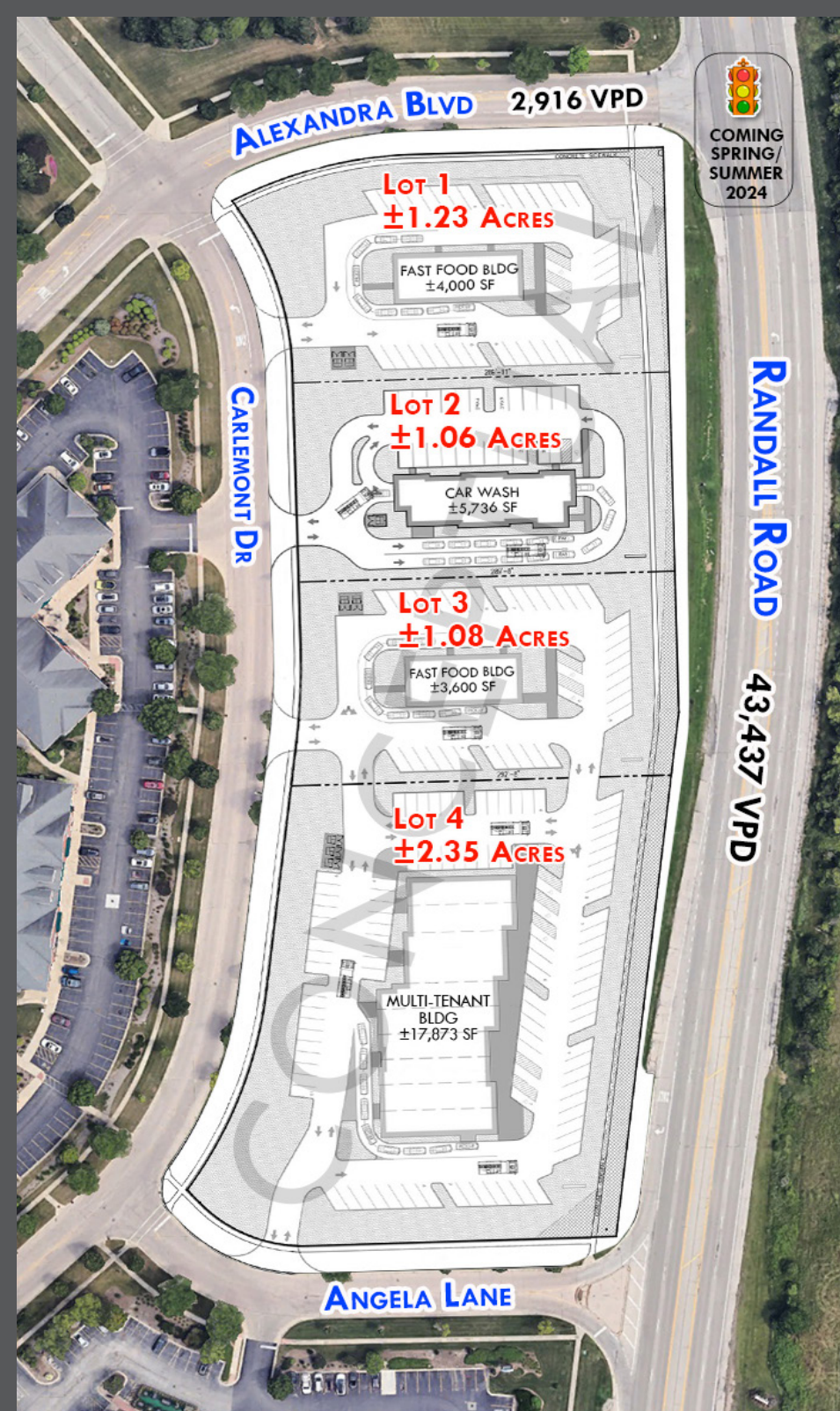

DEMOGRAPHICS

POPULATION

1 MILE	10,023
3 MILE	68,741
5 MILE	145,674

AVERAGE HH INCOME

1 MILE	\$129,738
3 MILE	\$146,445
5 MILE	\$152,039

PROPERTY HIGHLIGHTS

- Approved PUD/ Zoning - B2 General Commercial.
- Great visibility on Randall Road.
- Strong Demographics.
- High Traffic Counts.
- Strategically located to serve the Crystal Lake, Algonquin and Lake in the Hills communities.



CONTACT
INFORMATION

MATT SMETANA
630.572.5632
msmetana@edgemarkllc.com

MIKE WESLEY
630.572.5610
mwesley@edgemarkllc.com